

Technical Details

Particulars	MOOR -40	MOOR-50	MOOR-62
L.O.A (m)	12.00	15.20	19.00
L.W.L. (m)	10.10	13.15	16.60
BEAM (m)	3.14	4.00	4.90
DRAFT (m)	0.65	0.85	0.95
DISPLACEMENT (tons)	9.50	22.00	35.00
RECOMMENDED POWER (HP)x 2	350	700	1000
SPEED (knots)	UP TO 33	UP TO 33	UP TO 35
PROPULSION SYSTEM	Stern Drive/ Fixed Pitch	Fixed Pitch	Fixed Pitch
ELECTRICAL SYSTEM DC	12V	24V	24V
ELECTRICAL SYSTEM AC	Optional 220V	Optional 220V	220V-240V
STEERING SYSTEM	Hydraulic/Manual	Hydraulic/Manual	Hydraulic/Manual
HULL MATERIAL	G.R.P	G.R.P	G.R.P
SUPERSTRUCTURE MATERIAL	G.R.P	G.R.P	G.R.P
FUEL TANKS CAPACITY (LTRS.)	600-1000	1500-2500	2000-3500
AIR CONDITIONING	Optional Availability	Available	Available
BILGE SYSTEM	Independent	Sea chest	Sea chest
OTHER EQUIPMENTS	As per request	Aa per request	As per request
CLASSIFICATION (OPTIONAL)	B.V, G.L, DNV	B.V, G.L, DNV	B.V, G.L, DNV

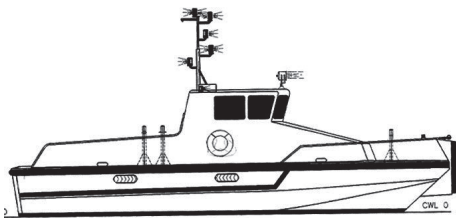

MOOR-40

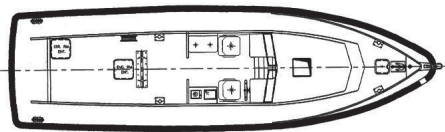

MAIN DECK

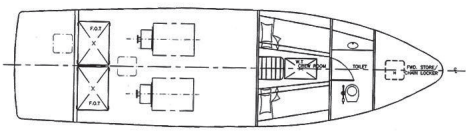

BELOW DECK

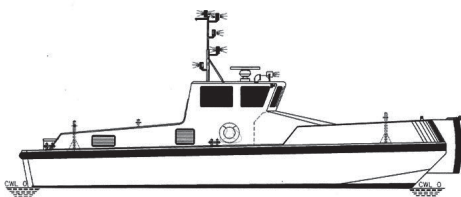

MOOR-50

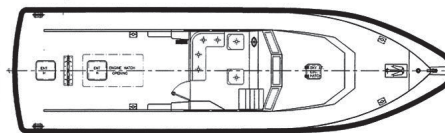

MAIN DECK

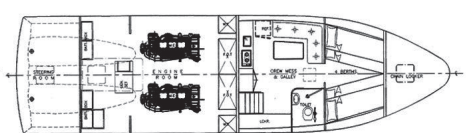

BELOW DECK

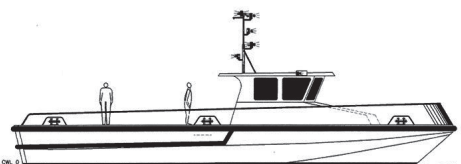

MOOR-62

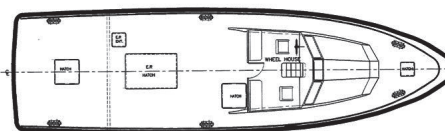

MAIN DECK

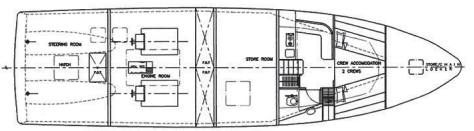

BELOW DECK